

Ice Storage and Transport Systems with SmartGATE®

Order parts online
www.follettice.com

Installation, Operation and Parts Manual

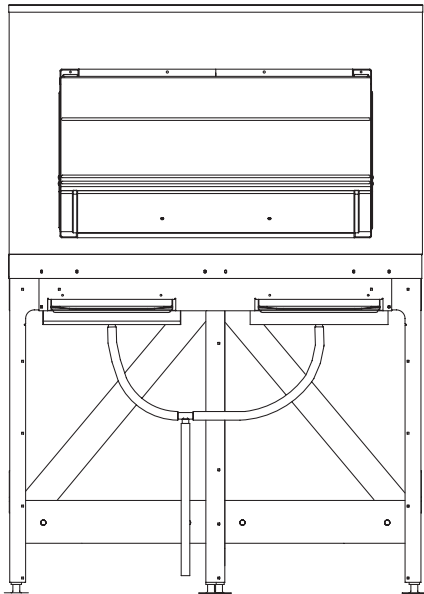

ITS1350-60

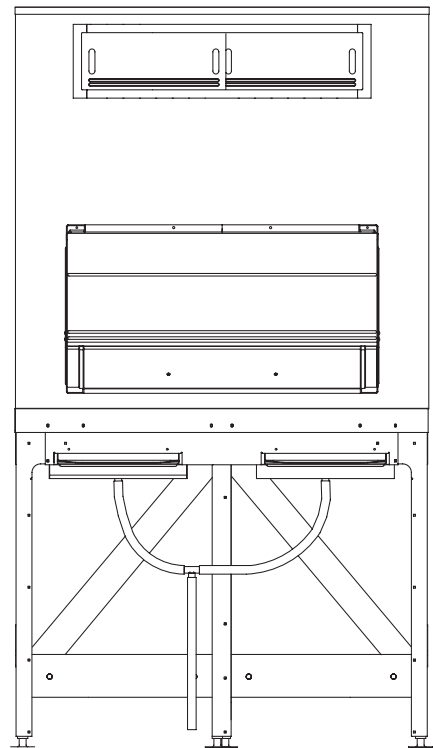

ITS2250-60

**Following installation, please forward this manual to the
appropriate operations person.**

Table of contents

Welcome to Follett Corporation	4
Important cautions	4
Installation	5
Uncrating and installing base section	5
Installing bin	5
Installing tie-down straps	5
Sealing bin interior	5
Plumbing connections	6
Affixing operating labels	6
Removing lower door assembly	6
Reinstalling door assembly	7
Ice guide adjustment	7
Repositioning of ice guides	7
Operation	8
Ice transport system operation	8
Breaking ice bridges	9
SmartGATE operation	9
Cleaning	10
Bin drain system cleaning	10
Drain tray cleaning	10
Shutter doors and rails	10
Interior bin care	10
Exterior bin care	11
Replacement parts	12

Follett Corporation Equipment Return Policy

Follett equipment may be returned for credit under the following conditions:

1. The equipment is new and unused.
2. A return authorization number has been issued by customer service within 30 days after shipment.
3. Follett receives the equipment at the factory in Easton, PA within 30 days after issuance of the return authorization number.
4. The equipment must be returned in Follett packaging. If the packaging has been damaged or discarded, Follett will forward, at the customer's expense, new packaging.

Note: Return freight charges are the responsibility of the customer. If equipment is returned and is damaged because of improper packaging, Follett Corporation will not be held responsible.

Credit will be issued when:
The equipment has been inspected by Follett and deemed suitable to be returned to stock.

Note: A 15% restocking charge will be deducted from the credit. If the cost to return the product to stock exceeds 15%, the actual cost will be deducted.

Welcome to Follett

Follett Ice Storage and Transport Systems enjoy a well-deserved reputation for excellent performance, long-term reliability and outstanding after-the-sale support. To ensure that this equipment delivers that same degree of service, we ask that you take a moment to review this manual before beginning the installation or operating the system. Should you have any questions or require technical help at any point, please call our technical service group, (800) 523-9361 or (610) 252-7301.

Before you begin

After uncrating and removing all packing material, inspect the equipment for concealed shipping damage. If damage is found, notify the shipper immediately and contact Follett Corporation so that we can help in the filing of a claim, if necessary.



Important cautions and operating rules

Read this manual completely before assembling or operating Ice Transport System. Follow the cautions and instructions listed below.

To avoid damage to Ice Transport System and injury during operation:

- Do not move Ice Transport System once icemaker has been installed
- Anchor flanged feet to floor as instructed on page 5
- Only use paddle provided to assist ice flow

To avoid injury during operation of unit:

- Keep entire body clear of bin when breaking up ice
- Keep head and face away from paddle handle when breaking up ice
- Keep floor around Ice Transport System free of ice and water

For best operation and to ensure delivery of clean, sanitary ice:

- Be sure bin system is level in both directions to provide proper drainage
- Position cart in bay before opening hopper door
- Install charcoal water filter on inlet water for icemaker
- Hang paddle implement in supplied bracket after each use
- Keep paddle clean and in good repair to avoid ice contamination
- Follow instructions in this manual for bin cleaning and maintenance
- Drain melt water from cart when positioned in bay by opening drain valve
- Keep glass, dirt and other foreign objects out of bin at all times

Installation

Uncrating and installing base section

1. Remove paddle from skid by cutting plastic straps.
2. Remove screws holding flanged feet and tie-down straps to skid and remove skid.
3. Remove packing material from inside of legs and around shutter door.
4. Position base in intended position and adjust feet to level unit in both directions.
5. Mark position of each flanged foot anchoring hole.
6. Move base out of way and install anchors for 1/4" bolts in floor (supplied by others).
7. Reposition unit in intended position and anchor base unit to floor through flanged feet.



When leveling, do not extend any leg more than 1" (26mm) for total leg height no greater than 2.125" (54mm).

Legs MUST be secured to floor through feet to avoid possible movement and resulting injury.

Installing bin

1. Remove 4 bolts fastening skid to underside of bin.
2. Remove all protective wrap from exterior.
3. Run 1/8" bead of supplied silastic in center of each gasket band on base.
4. Install bin section on base section, taking care that locating pins in base engage holes in bin.
5. Use fasteners provided to install paddle support bracket on right or left side of bin in holes provided.
6. Remove all tape and temporary fastenings from door assemblies and outside of bin.
7. Mount icemaker(s) on top of bin in accordance with icemaker manufacturer's instructions.
8. Install tie-down straps.

Fig. 1

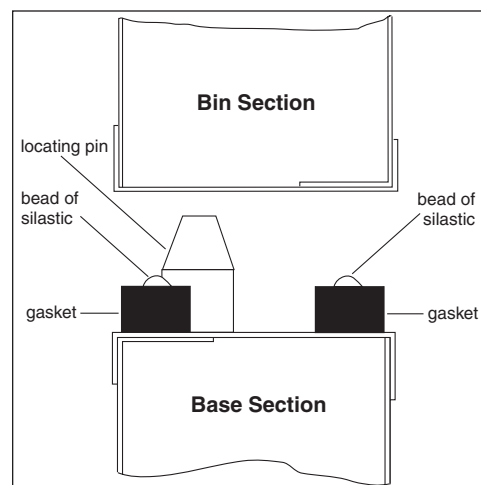

Installing tie-down straps



Tie-down straps to secure bin to base are provided on each side of unit. Straps MUST be installed to avoid possible injury should the unit move. Bolt unit to wall for increased stability, and bolt to floor to prevent side-to-side movement.

1. Remove screws from rivnuts on each side of bin section.
2. Reposition tie-down strap up until slot matches rivnut opening.
3. Reinstall screws in rivnuts and tighten.

Sealing bin interior



The joint between base and bin sections must be sealed with silastic to prevent leakage and/or ice contamination and potential voiding of warranty. One or more shutter doors may need to be removed to seal bin.

1. Support shutter door(s) with one hand and remove thumbscrews from side of shutter door(s) at underside of base.
2. Pivot door(s) downward to remove.
3. Gain access through this opening and seal entire perimeter of seam between bin and base with provided sealant or equivalent.
4. After sealant has set but before shutter door(s) have been reinstalled, clean inside of bin following instructions in this manual.
5. Reinstall shutter door(s).

Fig.2 – Use sealant provided to seal entire perimeter of seam where base and bin sections join.

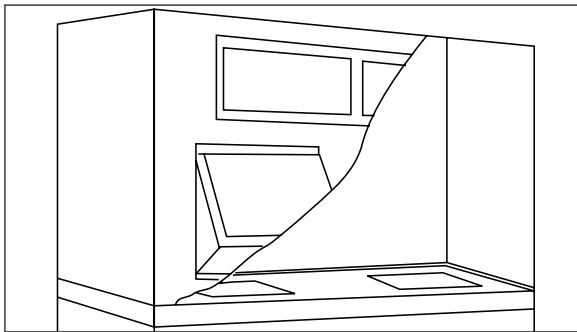
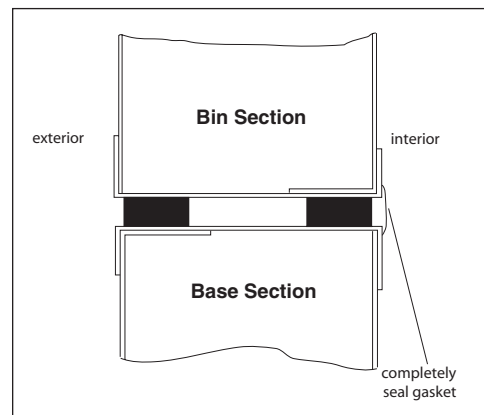

Fig. 3 – Cross section of ITS sections joined



Plumbing connections

Note: It is recommended that a full width grated floor drain be installed in front of bin.

1. Make final connections to icemaker.
2. Make final connections to vertical drain tube, 1" ID.

Affixing operating labels

Operating labels taped to base front educate staff to shutter door operation. If desired, these labels can be affixed **permanently** by peeling off back paper and affixing in locations desired.

Note: Adhesive backing is extremely strong and labels cannot be easily removed once installed.

Removing lower door assembly (only if required for access through narrow doors)

1. With lower access door closed remove Phillips head screw and washer from hinge area on each side of lower access door.
2. Insert screwdriver between door and hinge bracket on one side of door and gently push against bracket to provide room for door stud to clear bracket.
3. Remove access door.
4. Pull up on SmartGATE to remove.
5. Remove three or four (3 or 4) screws along top of door assembly.
6. Pull forward on assembly and remove.

Fig. 4

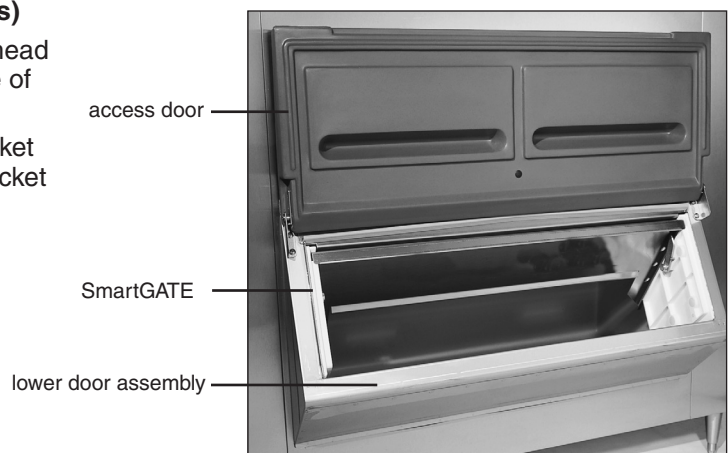

Reinstalling door assembly

1. Reinstall lower door assembly in bin opening.
2. Reinstall three or four (3 or 4) screws in hood at top of door assembly.
3. Reinstall SmartGATE in side panel tracks and push down to seat.
4. With door closed insert one door stud through hinge bracket.

Note: For proper operation the access door must be reinstalled in the closed position.

5. On other side, insert screwdriver between door and hinge bracket and gently push against bracket to provide room for door stud to clear bracket.
6. Reinstall washers and screws in lift door and tighten.
7. Check door to ensure proper operation.

Ice guide adjustment

Some ice types are very “slippery” and may flow over sides of cart when exiting hopper. Ice guides hang down below hopper and help contain flowing ice inside cart.

Guides are installed in highest position at factory, providing 3/4" clearance to top of cart when legs are in full down position. If legs are adjusted up during leveling of Ice Transport System, ice guides should be lowered to maintain 3/4" (19mm) clearance. Access to sides of Ice Transport System is required to perform operation.

To reposition ice guides after legs have been adjusted

1. Position cart in bay below shutter door opening.
2. Determine amount guides must be lowered to maintain 3/4" (19mm) clearance.
3. Remove thumbscrews holding guides.
4. Select hole to reposition guide at proper level and resecure with thumbscrew.
5. Repeat process for each bay in system.

Fig. 5

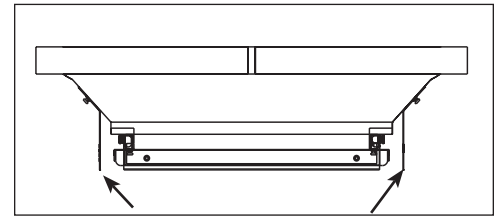

Brackets on underside of hopper to which ice guides are secured.

Operation

Ice Transport System Operation

A

Pushing cart into bay

1. PUSH cart all the way to back.

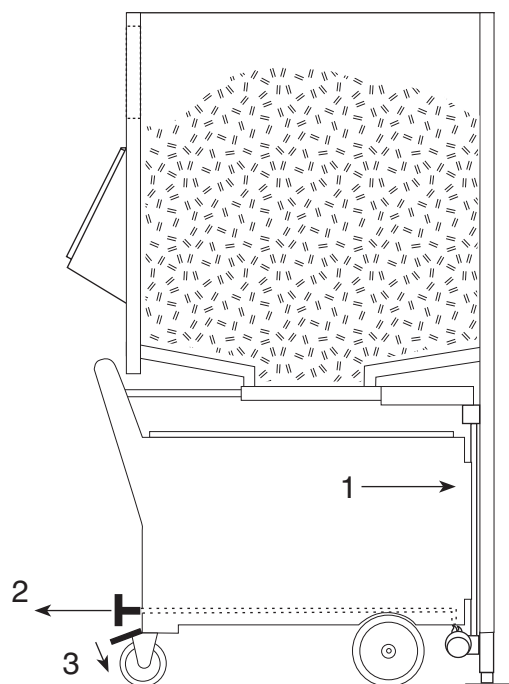

B

Loading ice

1. PULL shutter handle open.
2. Store handle up against bin.

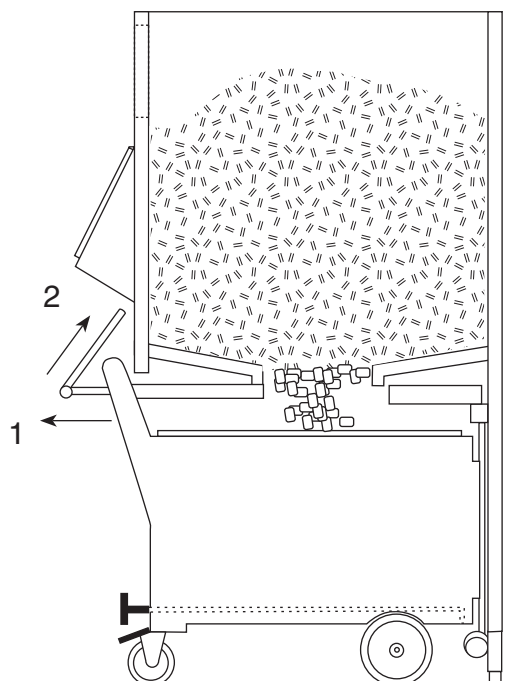

C

Pulling cart out

1. PUSH shutter handle closed.

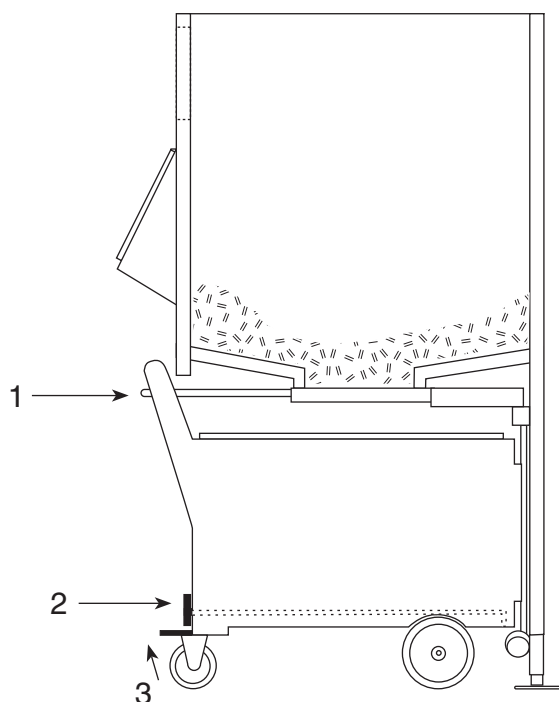

D

Transporting ice

1. PULL cart from base.

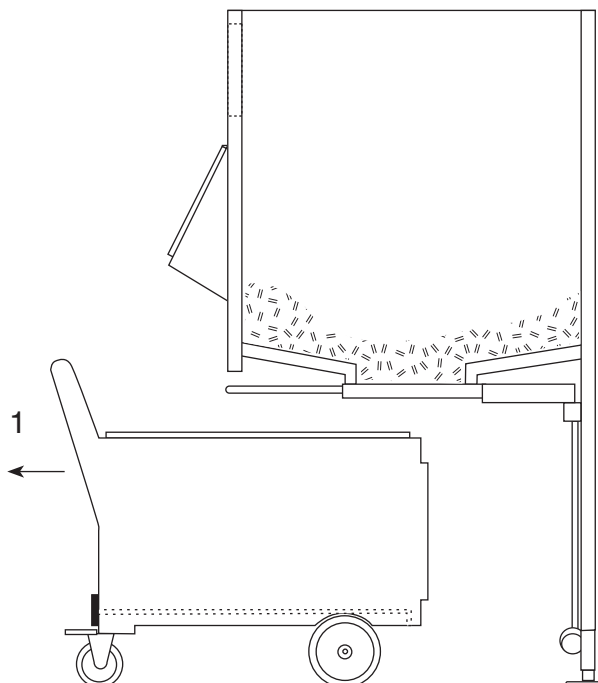

Breaking ice bridges

It may be necessary to use the paddle to break up ice bridges that occur along the sides and in the middle of the bin. This often happens if ice has been held in storage for a period of time without use.

Use supplied paddle accessory to break up bridges



Do NOT dig up at ice. Instead, break away "legs" that are holding bridges. Ice above will then fall.

To avoid injury, do not attempt to break up bridged ice through upper windows or hopper shutter door. A falling ice bridge can cause paddle to lift. Keep head and face away from paddle handle to avoid injury.

1. Completely knock down all ice from sides and back of bin.
2. Knock down any bridge that has occurred in middle.
3. Agitate paddle back and forth to break up congealed ice mass.

Fig. 6

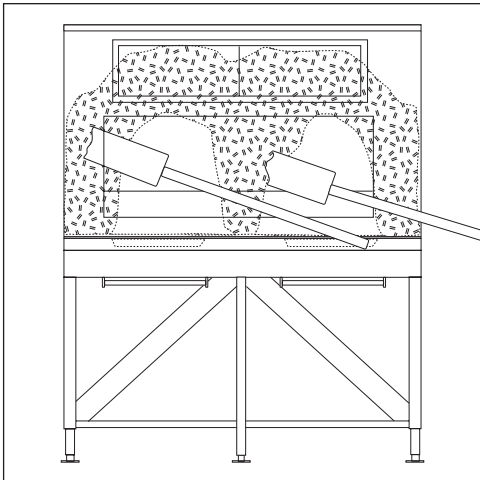
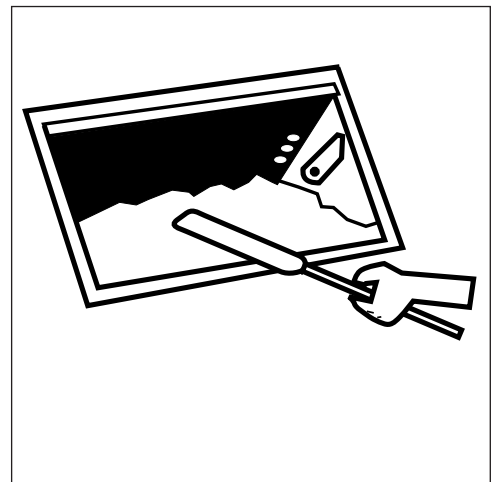

Fig. 7



SmartGATE operation

SmartGATE can be adjusted and locked at one of several levels to accommodate flow characteristics of different types of ice.

Bin is shipped with SmartGATE in full down position. SmartGATE can be raised and locked in higher position for better flow or when more access is needed.

Fig. 8

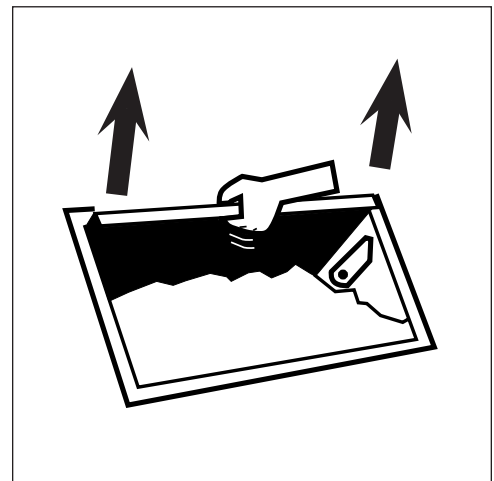

Cleaning



Clean and sanitize bin interior prior to use and on regular schedules as needed. Use non-chlorine based cleaner and sanitizer suitable for use in food zone. Do NOT use chlorine-based cleaners, which can cause staining and pitting of stainless steel components. Turn off icemakers(s) and remove ice from bin before beginning.

Bin drain system cleaning

1. Remove upper tray(s) and wash with cleaning solution, rinse and reposition in brackets.

Drain tray cleaning

1. Remove two thumbscrews on side of drain tray and pull drain tray forward to remove.
2. Wash with an approved cleaner.

Shutter doors and rails

1. Support hopper shutter door with one hand and remove thumbscrews from side of hopper shutter door at under side of base section.
2. Pivot door down to remove.
3. Wash door, rinse thoroughly and sanitize.
4. Remove thumbscrews holding front and rear of shutter tracks.
5. Wash tracks, rinse thoroughly and sanitize.

Cleaning bin before use and ongoing bin maintenance

Interior of bin must be cleaned and sanitized prior to use, and should be cleaned on routine basis during use.

Interior bin care

Follett ice storage bins with SmartGATE are equipped with polyethylene liner walls which should be cleaned and sanitized periodically with Ecolab Mikro-chlor Cleaner or any product suitable for use in a food zone.

Important: Follett Corporation recommends installing a properly-sized, activated carbon (charcoal) water filter on water supply to icemaker to remove chlorine.

1. Remove upper inspection windows by sliding windows to one side. Grasp the end of the front window and pull toward you as the window is slid to the opposite side. Repeat for rear window.



2. Wash bin walls, ice storage area, access door plate and partition (if any), rinse and sanitize.

Exterior bin care

Exterior stainless steel surfaces can be cleaned with a stainless steel cleaner such as 3M Stainless Steel Cleaner & Polish or equivalent.

Technical assistance available toll free

Should you have any questions concerning installation or maintenance of Follett ice storage bins, please call our technical service department at (800) 523-9361 or (610) 252-7301 between 8 a.m. and 5 p.m. Eastern time.

Replacement parts

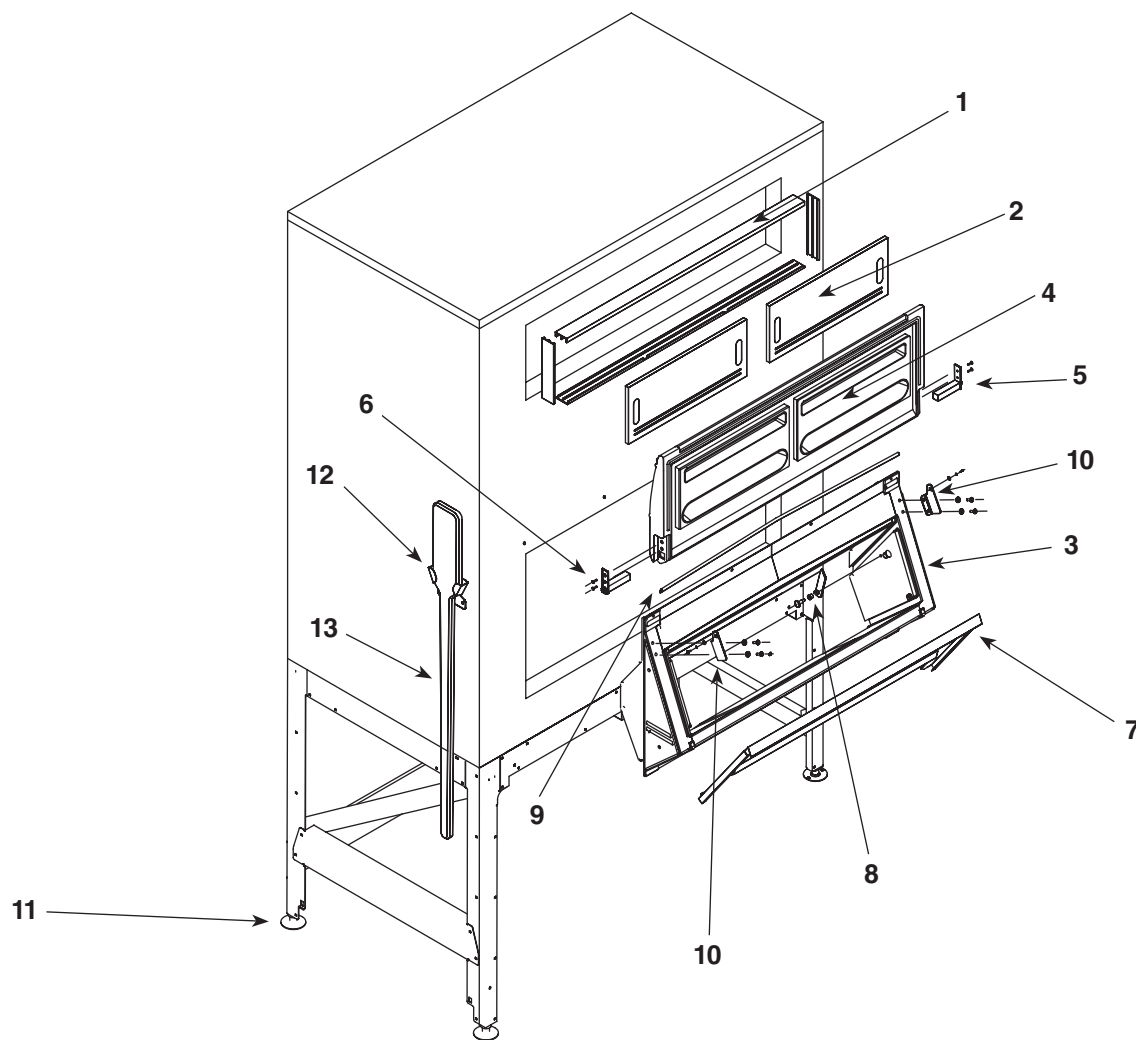

Reference #	Description	Part #
1	Track, inspection window, 42" (used with 502237 window) - 3200/2250	501277
2	Inspection window, 21.125"W x 8.625"H (2 used per bin) - 3200/2250	502237
3	Frame assembly, lower door, 45" (includes 502177 & 502182)	502361
4	Door, outer lift, 45" (includes 502178 & 502179)	502177
5	Hinge, RH door mount (includes hardware)	502179
6	Hinge, LH door mount (includes hardware)	502178
7	Ice Gate, 40", w/o holes	502182
8	Catch, Ice Gate	502185
9	Gasket, 41.5"	502364
10	Hinge bracket, bin mount, LH/RH, (pair, includes hardware)	502180
Not shown	Strap, hold down	502214
11	Foot, flanged (1), bolt base	502196
12	Bracket, ice paddle	502064
13	Paddle, ice	502063
Not shown	Shovel, ice	501796
Not shown	Bracket, ice shovel	502360

Drain system

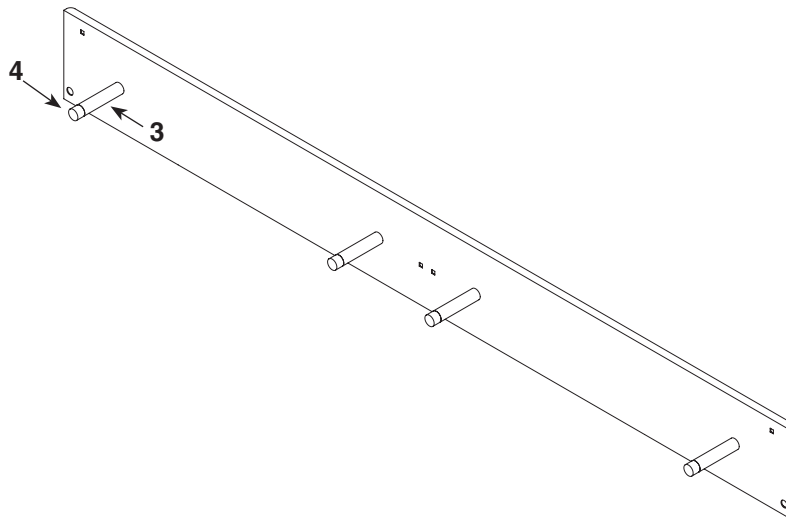
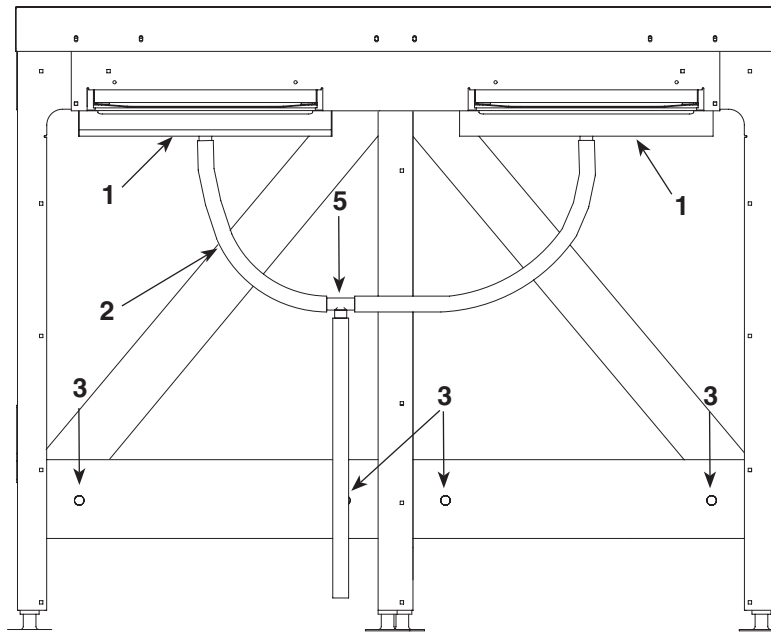

Reference #	Description	Part #
1	Drain pan upper – includes (2) 501100	00147652
2	Vertical drain tube – sold per foot	205149
3	Bumper, and stud – includes 502865	502849
4	Cap, bumper	502865
5	Tee	00147678

Shutter door assembly

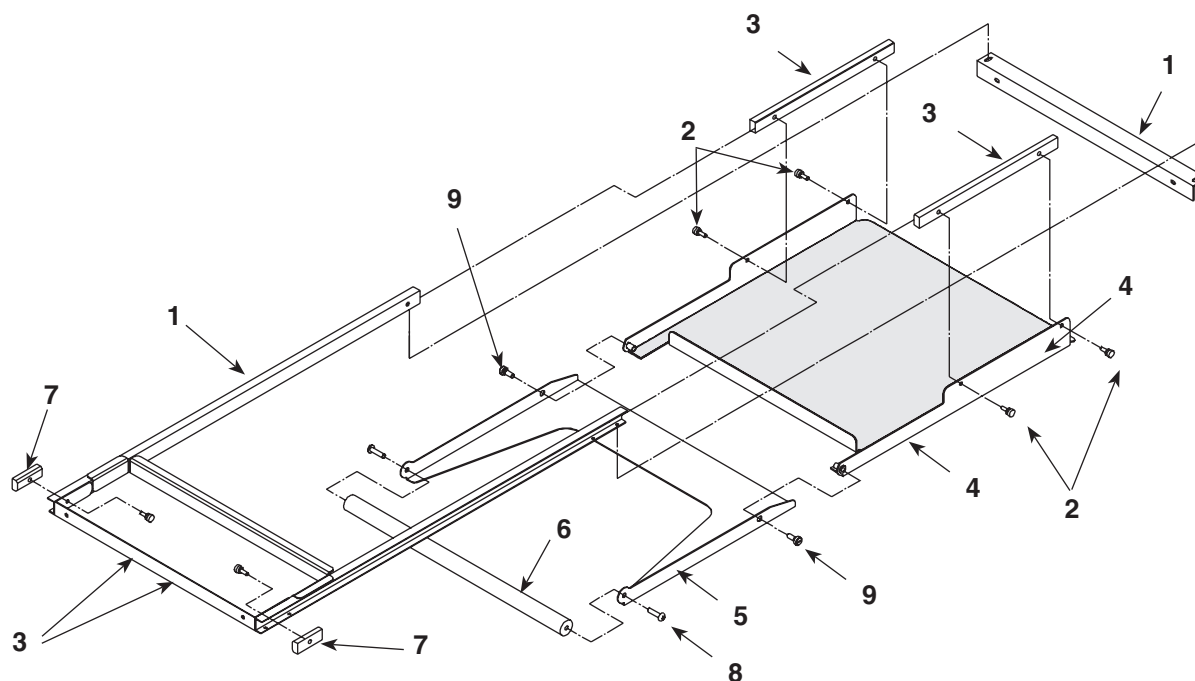

Multi-bay joint cover

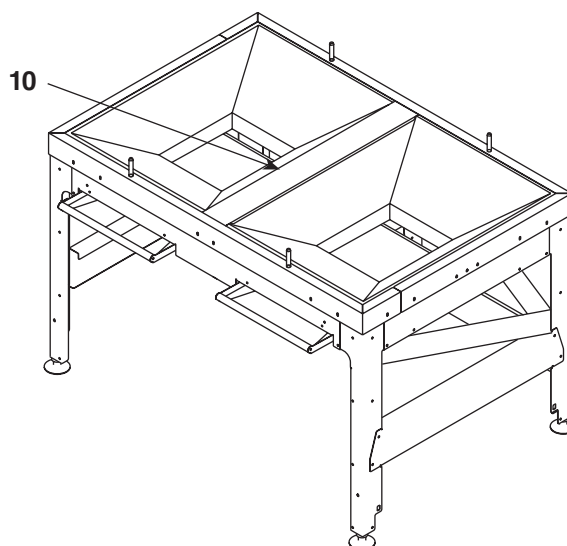

Reference #	Description	Part #
1	Track shutter door – includes (2) 502272, (8) 501100	502864
2	Thumbscrew, 10-32 X 1/2"	501100
3	Bearings (2), shutter door, nylon 11-7/16" – includes (4) 501100	502269
4	Shutter door – (includes 502857 and (2) 502272)	00147660
5	Assembly, handle, shutter door – includes 502858	502857
6	Rod handle, shutter door – includes (2) 502859	502858
7	Spacer, bearing – includes 501100	502272
8	Screw, shutter handle rod	502859
9	Shoulder screw, handle shutter door	502860
10	Cover, joint, two and three bay, blue hopper	00112821
Not shown	Ice guide – includes (2) 501100	502861
Not shown	Bracket, ice guide – includes (2) 501100	502863

SmartGATE is a registered trademark of Follett Corporation, registered in the US.



801 Church Lane • Easton, PA 18044, USA
Toll free (800) 523-9361 • (610) 252-7301
Fax (610) 250-0696 • www.follettice.com



00147694R00
10/10